

Finally, a motorhome that doesn't look like a box or ride like a truck.  
The GMC MotorHome.





## Our MotorHome warranty. Match it against the others.

### GMC MotorHome New Vehicle Warranty

#### What is warranted and for how long

GMC Truck (GMC Truck & Coach Division, General Motors Corporation) warrants to the owner of each GMC MotorHome (hereinafter called "MotorHome") that for a period of 12 months or 12,000 miles, whichever first occurs, it will repair any defective or malfunctioning part of the MotorHome—except tires and tubes which are warranted separately by the tire manufacturer. This warranty covers only repairs made necessary due to defects in material or workmanship.

The 12 month/12,000 mile warranty period shall begin on the date the MotorHome is delivered to the first retail purchaser or, if the MotorHome is first placed in service as a demonstrator or company MotorHome prior to sale at retail, on the date the MotorHome is first placed in such service.

#### What is not covered by the warranty

This warranty does not cover:

1. Conditions resulting from misuse, negligence, alteration, accident, lack of performance of required maintenance services, or overloading beyond the applicable weight rating;
2. Special body conversions or equipment not manufactured or supplied by GMC Truck;
3. Any part of the MotorHome which fails or malfunctions as a result of improper conversion or installation of special equipment by other manufacturers or suppliers;
4. The replacement of maintenance items (Such as spark plugs, ignition points, positive crankcase ventilation valve, filters, brake linings) made in connection with normal maintenance services;
5. Loss of time, inconvenience, loss of use of the MotorHome or other consequential damages;
6. Any MotorHome on which the odometer mileage has been altered and the MotorHome's actual mileage cannot be readily determined; or
7. Any MotorHome registered and normally operated outside the United States or Canada. The warranty for these MotorHomes shall be that authorized for the country in which the MotorHome is registered and normally operated.

#### GMC Truck's Obligations

1. Repairs qualifying under this warranty will be performed by any authorized GMC MotorHome Service Outlet within a reasonable time following delivery of the MotorHome to the Service Outlet's place of business.
2. GMC Truck will pay the authorized GMC MotorHome Service Outlet for any repairs under the warranty.

#### Owner's Obligations

1. The MotorHome must be delivered to an authorized GMC MotorHome Service Outlet's place of business during regular business hours for performance of warranty repairs or service adjustments.
2. The owner is responsible for maintenance services which may be performed at the owner's option by any repair outlet regularly performing such services.

This is the only express warranty applicable to the GMC MotorHome and GMC Truck neither assumes nor authorizes anyone to assume for it any other obligation or liability in connection with such MotorHome or chassis.

## Exterior Paint Colors



532—White



533—Camel



575—Bittersweet



577—Parrot Green



527—Pineapple Yellow



554—Sky Blue

## Exterior and Interior Color Availability

Exterior Color	Opt. No.	Interior Decor Group (Includes Front Accent Stripes)			
		690 Sequoia	692 Painted Desert	693 Glacier	695 Canyon Land
White	532	X	X	X	X
Camel	533	X	X	X	X
Pineapple Yellow	527	X	X		X
Parrot Green	577	X		X	
Bittersweet	575		X		X
Sky Blue	554			X	

### Factory Delivery Plan.

Your dealer can arrange factory delivery of your new MotorHome. At the final assembly plant (just outside Detroit), GMC experts will take you through every step of the MotorHome operation, check you out on every system in the vehicle. Then give you a highway check-out drive to familiarize you with the way your new MotorHome handles.

If you'd like, you can take a tour of the assembly line and watch MotorHomes being built.

### One-stop service.

### After-hour assistance.

Every GMC MotorHome dealer is a one-stop service center. If it comes on the MotorHome, he has the trained experts to look after it.

And remember, every GMC MotorHome owner has a toll-free phone number to use if after-hour assistance is needed. Dial that number and you'll get the name and location of the nearest representative set up to offer after-hour assistance.

Vehicles shown illustrate standard or available factory-installed equipment unless noted as dealer installed accessories. Items referred to as options or available are at extra cost. Different model applications of the components that are listed in accompanying tables as well as many other items of factory-installed equipment may be ordered through your GMC dealer.

The GMC MotorHome is manufactured on a continuing basis and does not have a model year designation and will not go through annual model year changes. GMC Truck & Coach Division reserves the right to make changes at any time without notice in prices, colors, materials, equipment, specifications and models and also to discontinue models. Data shown is basic information for the prospective buyer effective at time of issuance of this catalog. Dealer will provide complete up-to-date information on available equipment, specifications, etc. not shown here.



# The MotorHome from General Motors.

# GMC MotorHome Standard Specifications

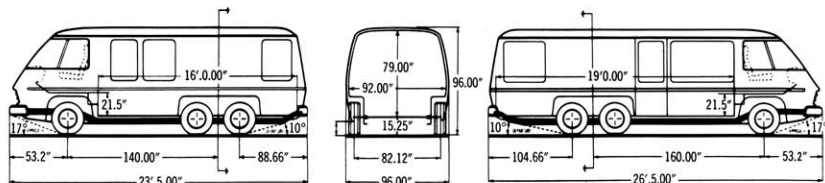

## Engine.

**Gasoline.** GMC 455, 8 cylinder, V-type. Net HP @ RPM (SAE) . . . . .265 @ 4300 Net Torque (lbs. ft.) @ RPM (SAE) . . . . .375 @ 2800 Comp. Ratio. 8.5:1.

**Air Cleaner.** Oiled paper element.

**Cooling.** Capacity: 21 qt. tube and center radiator, 9 lb. pressure cap. All season coolant, (-20°F), one 195°F thermostat, 19 in. 7 blade fan.

**Emission Control.** Conforms to Federal Standards.

**Oil Filter.** Throwaway type. 1 Qt. **Engine Oil Cooler**

## Transmission.

**Type.** 3 Spd. Turbo Hydra-matic HMT-425. Ratios: (2.0 converter) 3.45, 2.25, 1.41, 1.00; Rev. 5.02 with H.D. cooler.

## Rear Axle.

**Independently Suspended Tandem Wheels** (non-driving), capacity—7000 lbs.

**Air Suspension** with leading and trailing arms. Two height control valves.

**Shock Absorbers.** Four 1" Dia.

## Front Axle.

**Torsion Bar Suspension.** Rated capacity 4000 lbs.

**Shock Absorbers.** Two. 1" Dia.

**Steering Integral Gear Power Steering** (17.5:1 ratio).

**Final Drive Ratio.** 3.07:1.

Number of wheel turns, lock to lock; 2.95. Turn. dia. curb to curb: 56.41 ft.

## Brakes.

**Type.** Disc front, Drum rear (4) Vacuum boosted, w/dual (split) system and a combination valve which differentiates, meters and holds off front brake pressure until rear brakes contact the Drums.

**Effective Brake Lining Area.**

Front . . . . .37.88 sq. in.  
Rear . . . . .167.00 sq. in.

**Brake Size.**

Front (Disc Type) . . . . .11" x 1.205"  
Swept Area Per Axle (Sq. In.) . . . . .210  
Rear (Drum type—4) . . . . .11" x 2"  
Swept Area Per Axle (Sq. In.) . . . . .138

**Total Swept Area.**

(Sq. In.) . . . . .486

## Chassis.

**Frame.** Ladder type welded frame with 6 x 2.50 x .125 channel SAE 950 side rails and SAE 1023 channel cross-members.

**Bumpers.** Formed steel, painted silver, 2-piece front and rear. Energy absorbers—2 front and 2 rear.

## Fuel and Exhaust.

**Fuel Tanks.** Two 25 gal. tanks w/fuel tank gauge selector switch.

**Exhaust.** Dual mufflers and single tail pipe.

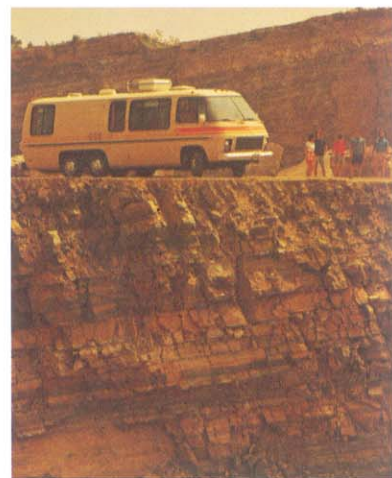

## Body.

**Sub-Structure.**

Heavy Gauged Alum. Extrusions.

Body Materials.

Fiberglass Frt. & Rear Caps & Lower Side Panels. Alum. Upper Side Panels & Roof.

Insulation. Frt. & Rear Caps. Wood Cellulose Fiber.

Main Body. Sprayed in Place Urethane Foam.

1" Treated Plywood Floor.

28" Wide Side Door.

**Windows.**

Windshield—Two Piece Laminated Tinted.

Driver Compt.—Side Windows—Sliding Laminated.

Living Area Windows—Two, Screened & Sliding.

Galley & Entrance Door Windows.

Bedroom Side Windows—Two, Screened & Sliding.

Bedroom Rear Window—One Piece Solid Tempered. Has Pop Out Escape Feature.

**Exterior Colors.**

Three (3) Std. Three (3) @ Extra Cost. Color Keyed Frt. Accent Stripes.

**Environmental Equipment.**

Heating. LPG Furnace—22,000 BTU (Forced Air).

Ventilation. Frt. Roof Mounted & Bathroom Gravity Ventilators.

Fire Extinguisher—2½ lb.

Water Supply. 40 Gal. Polyethylene Tank with 12V Demand Water Pump.

6 Gal. 110V Hot Water Heater.

City Water Hook-Up System with Locking Fill-cap Door.

Disposal. 32 Gal. Polyethylene Tank.

12 V DC Electrical System with 30 Amp. AC/DC Battery Converter/Charger.

110V AC—25 ft. 40 Amp. Power Cord.

LPG—44.5 lb. Propane Tank.

**Interior Electrical.**

All Lights 12V—Located As Follows: Dinette—(2) One L.H. Side—One R.H. Side

Corridor—(1)

Range Hood—(1)

Door Courtesy—(1)

Sink—(1)

Rear Compartment—(2)

Bathroom—(2)

Duplex Outlets—110V (4)

**Interior Finishing.**

Walls & Roof Insulated w/Foamed in Place Polyurethane.

Ceiling—Vinyl Covered Composite Panel.

Paneling—¾" Vinyl Covered Wood Panel.

Drapery—All Windows Ex. Windshield and Driver Compartment Side Windows. Driver Compartment Divider Drape. Carpet.

**Driver & Passenger Compartment.**

Adjustable Contoured Driver & Single Passenger Swivel Seats w/Armrests & Seat Belts.

Two Painted Outside (7½ x 10½) Fold-away Mirrors.

Inside Rear View Mirror.

Left & Right Hand Sun Shades.

Two Ash Trays.

Dome Lamps—Driver & Passenger.

Safety Padded Dash.

Automotive Heater & Defroster.

Glove Compartment.

Map Pocket—Driver & Passenger.

**Instruments & Controls.**

Windshield Wiper/Washer (Hydraulic Wipers). Variable-speed.

Heater & Defroster, Lighter, Speedometer, Fuel, Temp., Oil, Gen. Gauges.

Brake Warning Light.

Key Buzzer Warning System.

Telltale Light—Door Open.

**Living Compartment.** (Front).

Main Dinette. Removable Folding Leg Table Used to Convert Area to Double Bed—R. H. Side on 26-ft., L. H. Side on 23-ft.

4 Seat Belts.

Davo—Converts to Upper & Low Bunk Beds (30" x 76") L.H. Side (26-ft. only).

**Galley Area.**

Refrigerator—6 Cu. Ft. All Electric, 12V/110V

Range—3 Burner with Oven & Hood, 12V Fan & Light.

Sink—17" x 24" Stainless Steel Dbl. Bowl w/Ledge Back & Swing Spout Faucet.

Cabinets—Under and Over Sink & Refrigerator.

**Rear Bedroom.**

Permanent Double Bed.

Storage Locker.

Rear Upper Cabinets on Each Side.

**Bathroom.**

Two Piece Molded Fiberglass Reinforced Plastic w/Shower & Curtain.

Sink and Faucet.

Medicine Chest w/Mirror.

Thetford 41 Aquamagic® Toilet.

**Hall.**

Storage Compt. (Closet, Three Drawers & 2 Doors).

## Electrical.

**Battery.** 2-12V 73 amp. hr.

**Alternator.** 12V, 61 amp. Delcotron.

**Headlights**—Single 7" High Intensity. Amber Frt. Turn Directionals.

Combination Stop, Tail, Turn & Backup.

Five Amber (2 Clearance, 3 Identification) Marker Lamps Upper Front

Five Red Marker Lamps Upper Rear

Side Markers (Frt. & Rear With Reflectors—Front Flash With Turn Signals)

4-Way Emergency Flashers

Porch Light

## Wheels—Tires.

**Tires.** (6) 8.75 x 16.5 (D Load Range) Blackwall. Max. Tire Capacity (Ea.) 2350.

**Wheels.** 16.5-6K. 8 stud with 6½" bolt circle. Offset: 4.67".

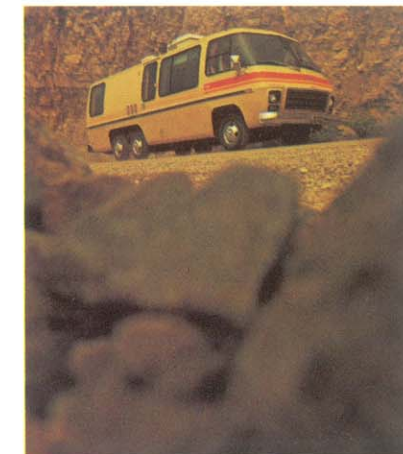

## All this is available on the GMC MotorHome to make it your GMC MotorHome.

### Chassis and Body

Air Conditioning—Automotive Type  
 Side Accent Stripes  
 Cruise Control  
 Lamp—Engine Compartment  
 Radio—AM with 4 Speakers  
 Radio—AM/FM Monaural with 4 Speakers  
 Radio—AM/FM Stereo with 4 Speakers  
 Radio—AM/Stereo Tape Player with 4 Speakers  
 Radio—AM/FM Stereo with Tape Player with 4 Speakers  
 Dual Passenger Seat  
 Tilt Steering Column  
 Thermometer—Outside  
 Warning Lights  
 Windows—Dark Tinted

### Exterior Trim Options

Bumpers—Chrome  
 Mirrors—Stainless Steel  
 Wheel Covers—Disc (6)  
 Wheel Covers—Disc (7)

### Operating—Handling and Performance Options

Alternator—80 Amp.  
 Fuel Evaporating Emission Systems (Mandatory in California)  
 Suspension Leveler—Power  
 Trailer Wiring Harness

### Wheels—Tires

8.75 x 16.5 DB/W—Front, Rear and Spare  
 8.75 x 16.5 DW/W—Front, Rear and Spare  
 8.75 x 16.5 D Steel Belt B/W Front, Rear and Spare  
 8.75 x 16.5 D Steel Belt W/W Front, Rear and Spare  
 Spare Wheel  
 Carrier—Spare Tire

### INTERIOR—AVAILABLE EQUIPMENT

#### Comfort and Convenience Options

Clock—Battery Operated  
 Drapery—Windshield and Side Window  
 Dinette—Main—Fully Upholstered  
 Lights—Aisle and Compartment

Locker—Boot  
 Luggage Carrier with Ladder  
 Monitor Panel  
 Toilet—Recirculating Chemical  
 TV Antenna  
 Vacuum Cleaner—Built In\*  
 Ventilator—Roof, Rear Power Exhaust  
 Ventilator—Roof Rear, Non-Power  
 Ventilator—Roof Front, Power Exhaust  
 Ventilator—Roof Center, Non-Power\*  
 Waste Disposal—Thermasan  
 Water Heater—Electric with Engine Pre-Heat

### Cabinets and Tables

Cabinets—Overhead Front R.H.\*  
 Cabinets—Overhead Front L.H.  
 Cabinets—R.H. Front with Traditional Carved Doors\*  
 Cabinets—L.H. Front with Traditional Carved Doors  
 Cabinets—Rear Overhead with Traditional Carved Doors  
 Closet—At Entrance Door\*  
 Galley—Doors and Drawers—Traditional  
 Table—Cocktail Rear  
 Table—Driver's Compartment  
 Table—Rear Dining

### Generator, Heating and Air Conditioning

Air Conditioning—Roof Mounted  
 Aux. Motor Generator 4,000 Watt Onan  
 Aux. Motor Generator 6,000 Watt Onan\*  
 Aux. Motor Generator 4,000 Watt Kohler  
 Aux. Motor Generator 6,000 Watt Kohler\*  
 Converter—AC/DC H.D. 45 Amp.  
 LPG Tank—62 Lbs.\*  
 LPG Furnace—30,000 BTU.  
 Pre-Wire for Air Conditioning

### Kitchen Options

Range—4 Burner  
 Refrigerator—7.5 Cu. Ft. All Electric\*  
 Refrigerator—7 Cu. Ft. Gas/Electric\*  
 Refrigerator—6 Cu. Ft. Gas/Electric  
 Water Purifier

\*Available on 26' model only

## The 23-foot MotorHome. 4 floor plans available.

Like the 26-foot MotorHome, the 23-foot gives you a lot of choice. You have the same choice of four interior color combinations. As well as six exterior colors.

In the living room, you have two modules to select from. In the rear bedroom, there are four available. One of them even lets you convert the rear bedroom into a dinette.

And the single front passenger seat can be replaced with an available swiveling dual passenger seat†.

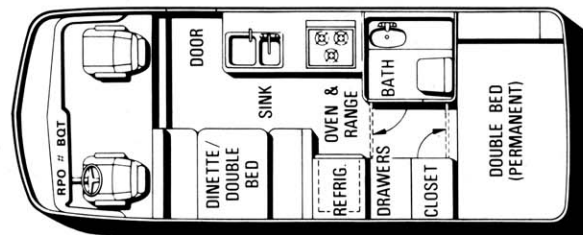

Base Floor Plan 23'-1

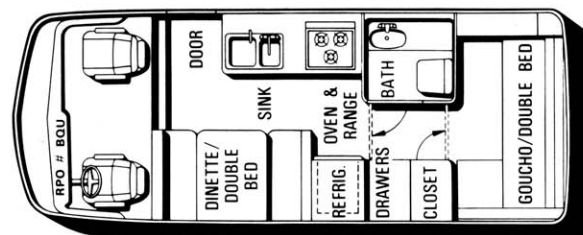

Floor Plan 23'-2

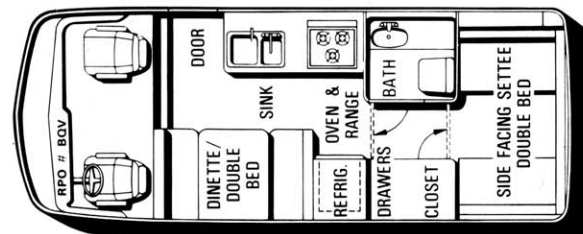

Floor Plan 23'-3

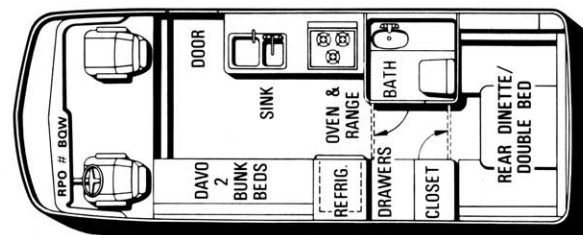

Floor Plan 23'-4

†Does not swivel on 26-foot model.

# The 26-foot MotorHome.

## 11 floor plans available.

Everybody doesn't have the same size family. Or the same travel plans. So we've made it easy for you to order almost any combination of interior modules to match your

MotorHome to your ideas.

There are two different units that fit in the right side of the living room. Three possibilities for the left side. And three different layouts for the rear.

And for even more variety, the passenger's seat in the cockpit can be replaced with a dual passenger seat.

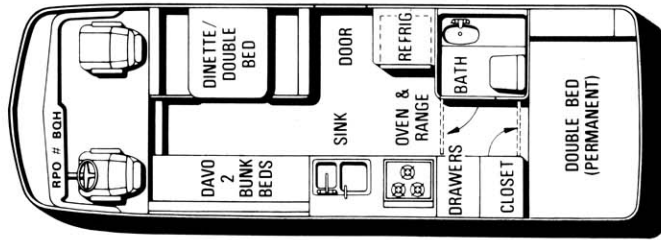

Base Floor Plan 26'-1

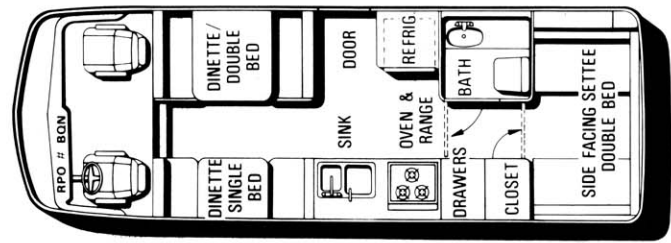

Floor Plan 26'-6

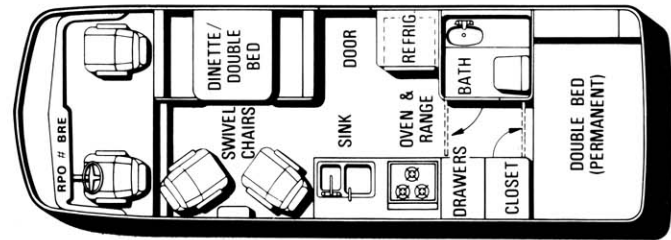

Floor Plan 26'-7

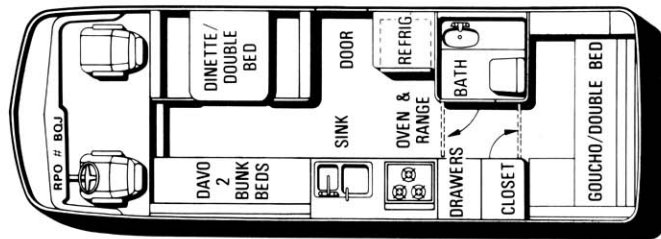

Floor Plan 26'-2

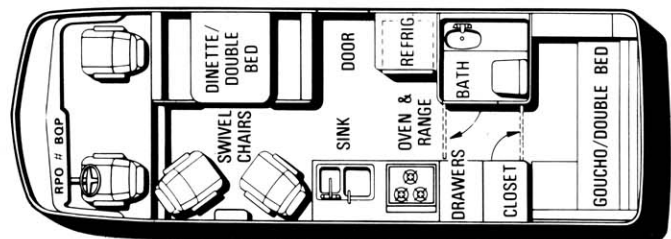

Floor Plan 26'-8

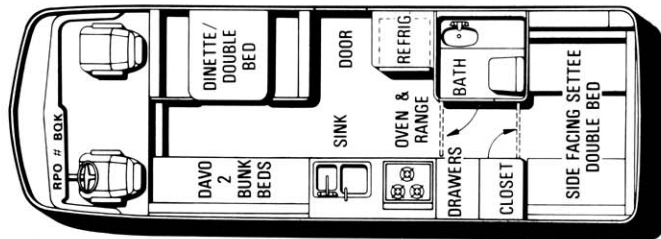

Floor Plan 26'-3

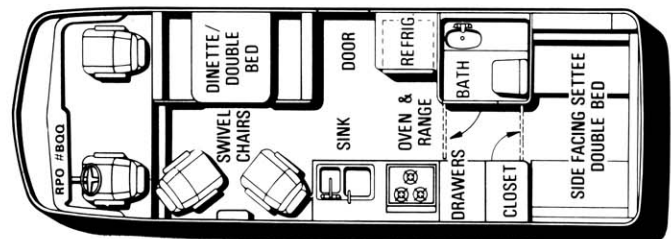

Floor Plan 26'-9

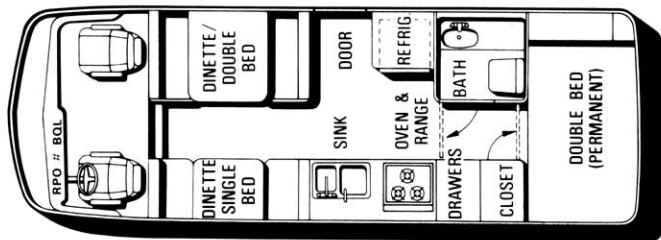

Floor Plan 26'-4

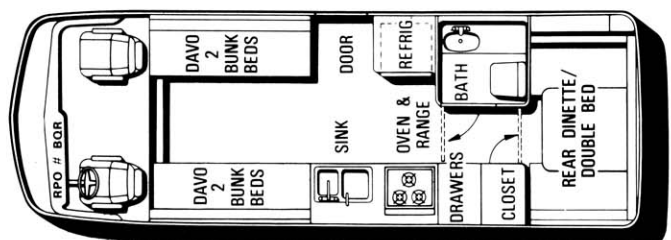

Floor Plan 26'-10

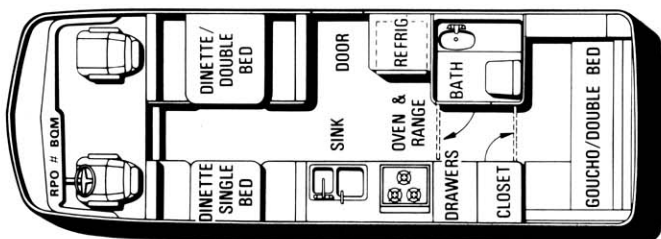

Floor Plan 26'-5

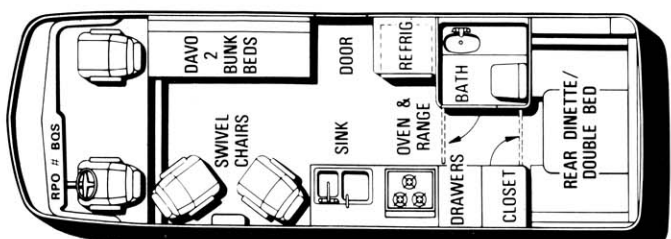

Floor Plan 26'-11



## Everything you need to see what's on the other side of the mountain.

There is a pine-covered peninsula in Maine that juts into the Atlantic Ocean. It is the first piece of America touched by the rising sun every morning. There are no motels, no parking lots, no restaurants. But there is a road there a motorhome can comfortably drive down.

And south of Arizona, in the Mexican state of Sonora, is a cliff high above the Gulf of California. The cliff that the Spanish conquistador, Cortez, stood on when he discovered the gulf that is still often called

the Sea of Cortez.

Again, no motels, no electricity, no guided tours. Just a dirt road and more than enough space for your motorhome.

Or maybe you've always wanted a cottage on the lake. Or a ski chalet in the mountains. Or a fishing lodge next to your favorite stream.

A GMC MotorHome can be all these things. Because with its standard and available equipment, you go self-contained. When and where you please.

Isn't it time you took a look at what's beyond the motels and the parking lots? Isn't that really why you want a GMC? Isn't it time you found the other side of the mountain? We're ready if you are.

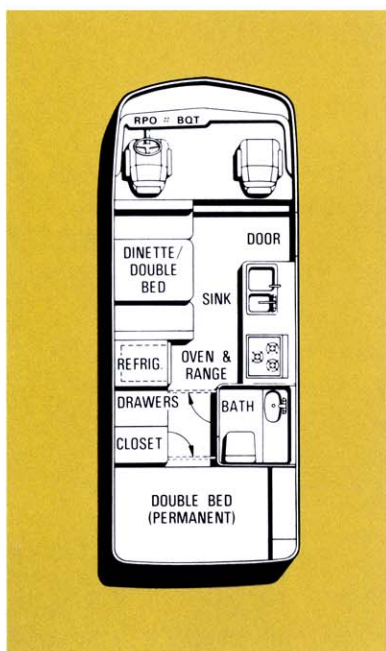

**The GMC 23-foot MotorHome has just about everything our 26-foot has, with something else.**

**A lower price.**

The 23-foot MotorHome has the same galley equipment, the same stove and refrigerator, the same bath, the same cupboard and closet space . . . they're just moved around a little bit.

The rear bedroom is identical to the 26-foot MotorHome; the major difference is in the front living area. Instead of a dinette and a couch, you can choose the available

dinette or couch. Just like the larger MotorHome, the couch converts to two bunk beds, the dinette turns into a double bed.

In the rear, you have the same standard double bed as the 26-footer. And the same available options of the gauchou couch/double bed or table and side settee/double bed.

And the same standard privacy feature. The bath and closet doors both open to create two completely separate compartments.

Of course, the quality of the furniture is the same high level as the 26-foot MotorHome. You get the same luxurious, five-inch thick, high density polyfoam cushions. The same quality

everywhere. All you miss are three feet and a double bed.

In either case, however, you benefit from the extensive testing and development that went into perfecting the MotorHome.

We started by running a prototype MotorHome on special torture roads. Then we set up computers to simulate that same abuse on a MotorHome running in our lab. This computerized testing let us pack the equivalent of several years of road tests into a seven-month program.

The vehicle shake test, for example, equalled the kind of pounding a motorhome could take in 150,000 miles of actual road use.



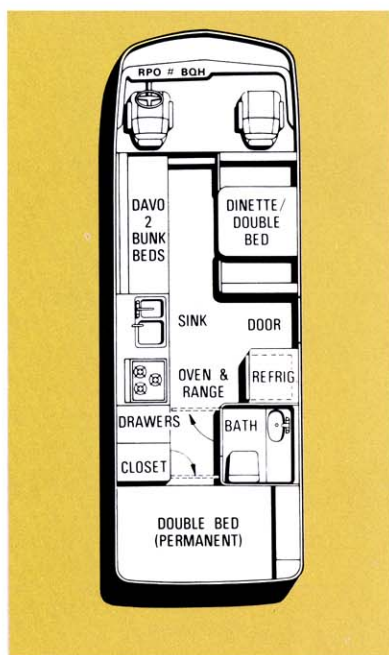
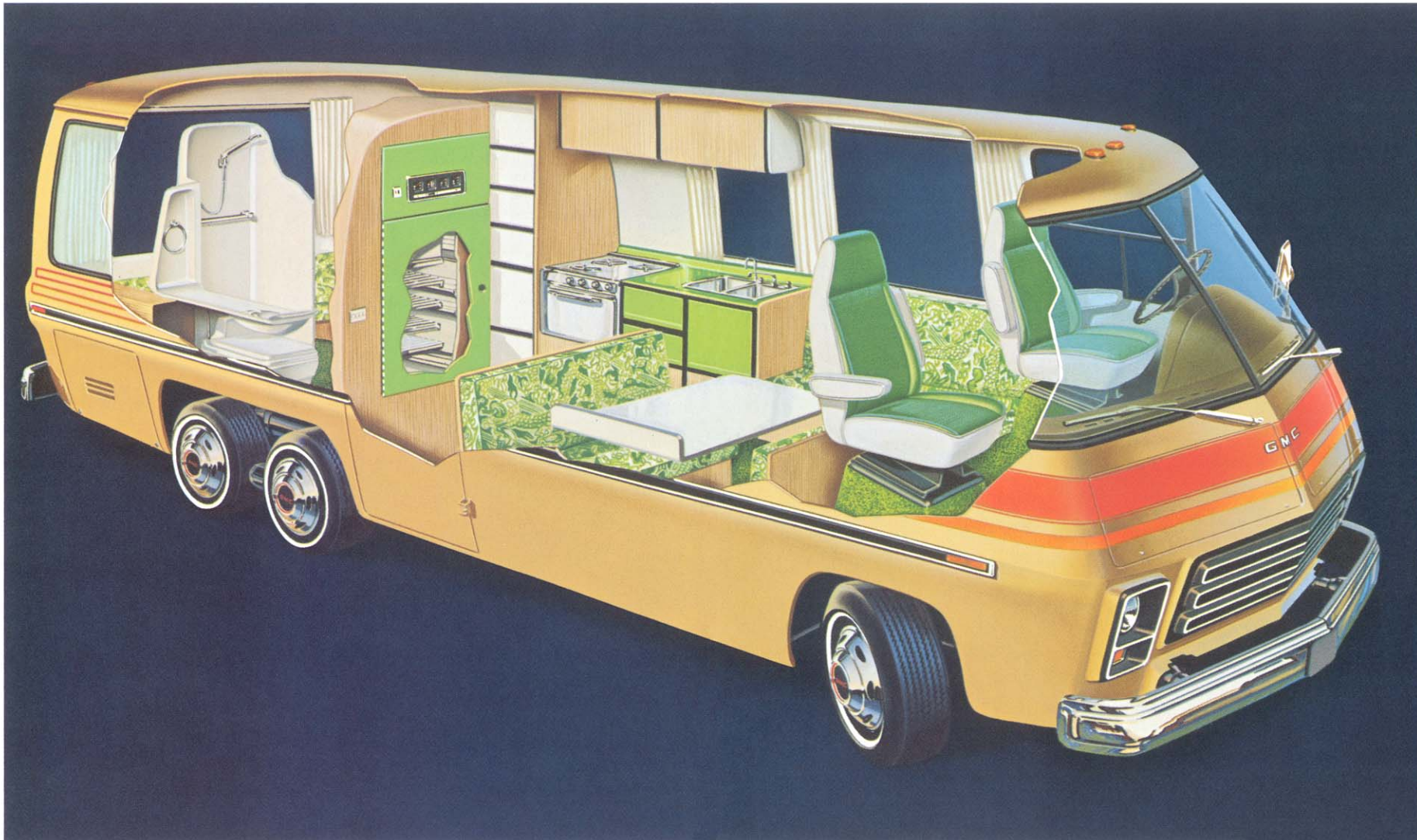

## The GMC 26-foot MotorHome is just what a custom-built home should be.

### A reflection of you.

When we say custom-built, we mean it. Not just one standard floor plan, but a variety of units you can tailor to fit your family or personal needs.

Just as important, you can select any floor plan without worrying about what it might do to ride or handling. We took a tip from aircraft designers and fed all the data on weights and locations into computers. Then we knew what combinations would keep weight and

balance within design limits. In the 26-foot model, for example, you can choose from 11 different combinations that pass the computer test!

The standard interior features a dinette on the right with facing seats and table that converts to a double bed.

On the other side of the room is a side sofa that turns into two bunks. If you so specify, you can have an auxiliary dinette that converts to a single bed. Or a pair of swivel chairs, matching the cockpit, with fold-up coffee table.

In the rear living area is a double bed. In its place, you can order a gauchou couch/double bed, or a table and side-facing settee/double bed.

But whichever combination you select, underneath is one of the MotorHome's most welcome features: insulation. Before the interior is ever installed, we spray the entire inner body shell with foam-in-place polyurethane insulation, at least  $\frac{3}{4}$  of an inch thick. This rigid foam has twice the insulating ability of fiberglass. Which means the GMC MotorHome has more efficient insulation than most homes, on or off wheels.

And in addition to insulating from heat or cold, the foam does a very good job of helping seal out road noise, too.

We know you want the MotorHome to be as comfortable as any home you own.



Sequoia

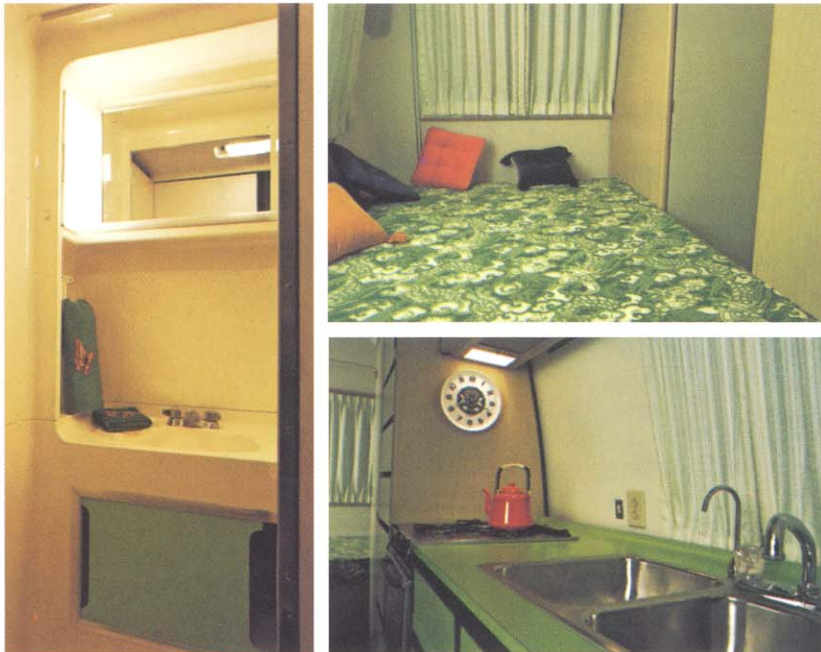

**A motorhome should be able to take a heap of living without showing it.**

**Ours can.**

When you invest in a motorhome, you plan to keep it a long time.

That's why we've relied extensively on the same long-life, easy-care materials you use in any modern home. All the heavy-use areas like counter tops, drawer fronts and cupboard doors (even the hallway) are faced with an attractive, tough and scuff-resistant surface. The carpeting and drapes are foam rubber-backed for long life and

excellent dirt resistance.

And to help take care of wear or accidental damage, all the cushion covers are zippered, removable and easy to clean or replace.

The basic MotorHome construction, with its bonded body panels, helps prevent outside air leaks that can funnel in dust from the road. And the window seals act as an effective dirt barrier when the windows are closed. With the windows open, full-size aluminum screens let you take in outside air while keeping insects in their proper place.

If you're looking for a motorhome that's as easy to care for as it is to enjoy, you're looking in the right place.



Glacier



**If our interiors look like they came out of a magazine, it's because they did.**

We combined the talents of the GM Design Studio and *House and Garden* magazine's design coordinators to style and select the fabrics, colors and finishes for our new MotorHome.

There's a choice of four standard interior decors with all colors and materials carefully co-ordinated.

The thick carpet, the counter tops, door panels and the drapes were all especially created to complement each other as well as the fine-grained, vinyl paneling on the

walls and kitchen cabinets.

And every homemaker will appreciate the amount of kitchen cabinet space we've built in.

There's plenty. Both under and over the sink and the refrigerator.

But we didn't stop with designing the interior just to look good.

When a GMC MotorHome interior is installed, everything is done by a team of four people. From beginning to end. When they finish, these people have seen the entire unit through everything needed to make it a home.

If that sounds like a return to old-fashioned pride of craftsmanship, you're absolutely right.



Canyonlands



### **The living room in our MotorHome is as advanced as what's under it.**

The GMC's ground-to-floor height is only 15 inches (that's 3 inches lower than the seat on your kitchen chair) so you can step aboard easily. And once aboard, six-foot 4-inches of headroom gives plenty of maneuvering room.

Every counter top has rounded corners and the overhead cabinets are flush-sided. All knobs are eliminated. Even the hinges are concealed. And all work areas have "toe-space" so you can get close.

The same comfort engineering was used in the galley.

There's a double sink, standard. And the standard six-cubic-foot refrigerator is electric so you don't have to worry about the pilot blowing out. But there is an available gas/electric unit, if you prefer.

The range and oven are LP gas, as is the thermostat-controlled furnace. The one-piece molded fiberglass bath module includes a flex-hose shower head as well as a mirrored, sliding door medicine cabinet, stainless steel sink and Aquamagic® toilet.

When we built the MotorHome, we wanted to make sure the family would feel as at home in it as they do at home. After all, a house is meant for a family, right?



Painted Desert



**Half of every trip is getting there. The MotorHome handles that with ease.**

When you sit in the command seat of your GMC MotorHome, you are truly a "king of the road". You're riding on your own, private magic carpet.

The inside quiet will make you think of a fine passenger car. The entire body is rubber-insulated from the chassis, and there's a specially treated, one-inch thick, exterior grade plywood floor to further block road noise.

Up front, the view is really something to behold.

Twenty-three square feet of windshield safety glass for

panoramic front and side vision. And big, bus-sized windshield wipers have the washers built right into them so the fluid hits right in front of the blade.

And the standard power steering and power brakes give you a road feel and handling close to a luxury car.

The GMC MotorHome weighs 2,000 to 3,000 pounds less than most comparably sized motorhomes. That, plus the standard 455-cubic-inch V8 engine, means you can accelerate to freeway speeds quickly. Or, take on mountain grades comfortably.

Just because you may be going to a wilderness doesn't mean you should have to rough it.

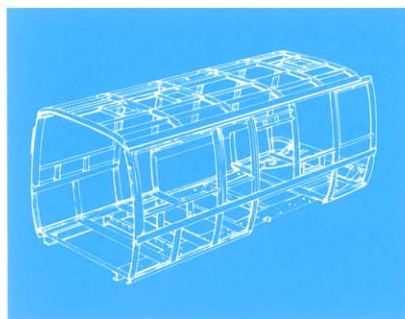
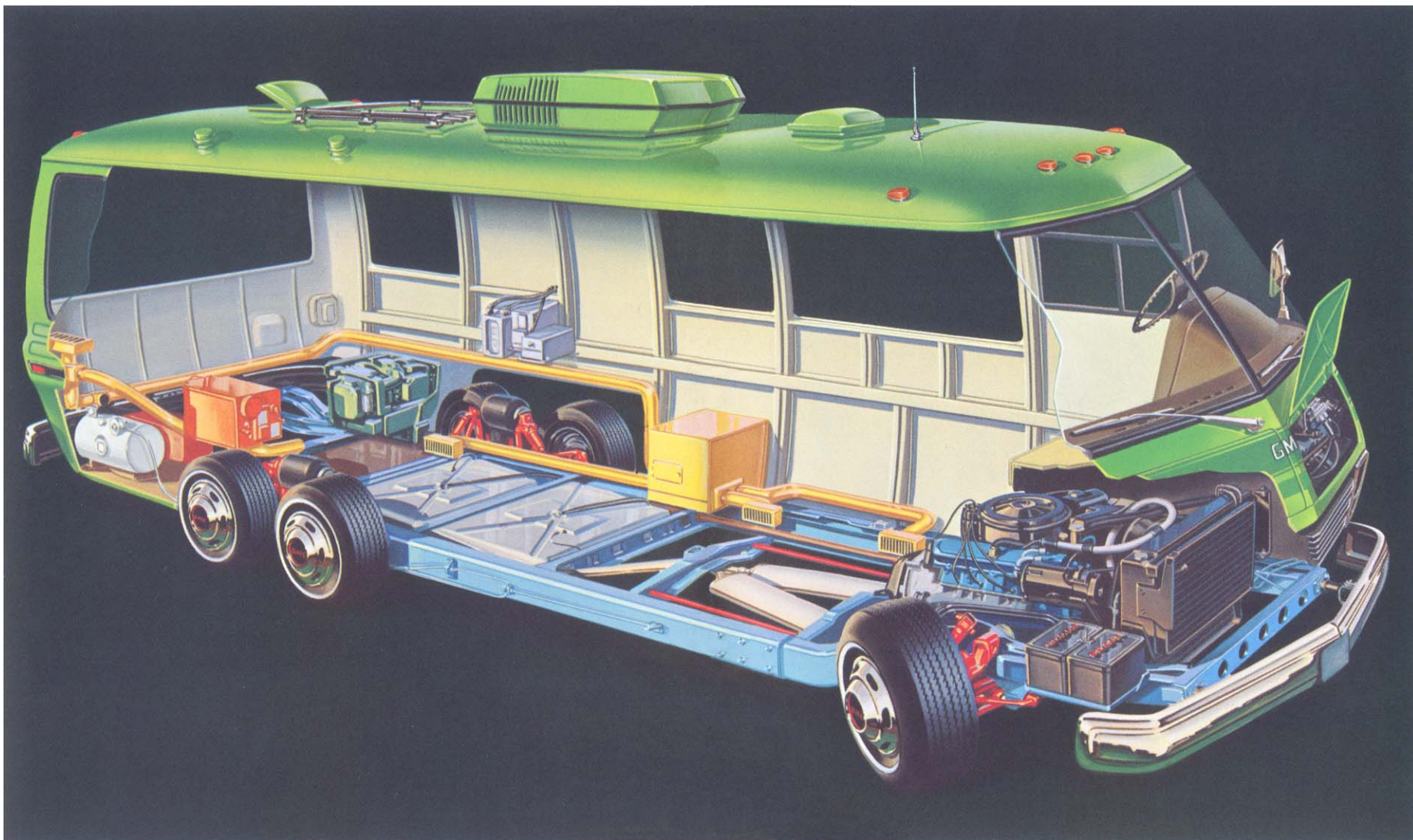

## **Buses don't get traded in every couple of years.**

When you build a bus that has to cover millions of tough, over-the-highway miles, or make hundreds of thousands of stops and starts on crowded city streets, you have to do one thing.

You have to build it tough.

And the big buses with the GMC nameplate on them have, for nearly 50 years, earned their reputation for strength and durability that lasts.

Year after year.

We used a lot of what we learned from building buses when we started designing the GMC MotorHome.

## **Neither should motorhomes.**

Like you, we think a motorhome should be a lasting place. So, on top of the wide steel chassis, we put a complete cage of heavy-gage aluminum ribs and stringers. Like an aircraft fuselage.

Then, on top of this tough substructure, we bond skin panels with the same techniques used on jumbo jets. The lower skin panels, as well as the nose and rear sections, are molded fiberglass for an extremely fine surface finish as well as resistance to corrosion. The roof and upper side panels are mirror-smooth aluminum. Tough and light.

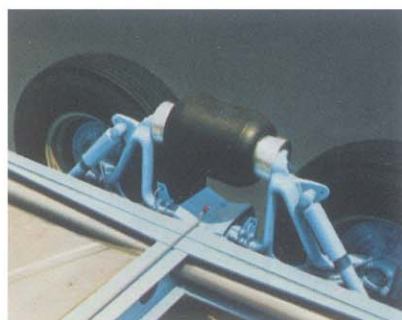
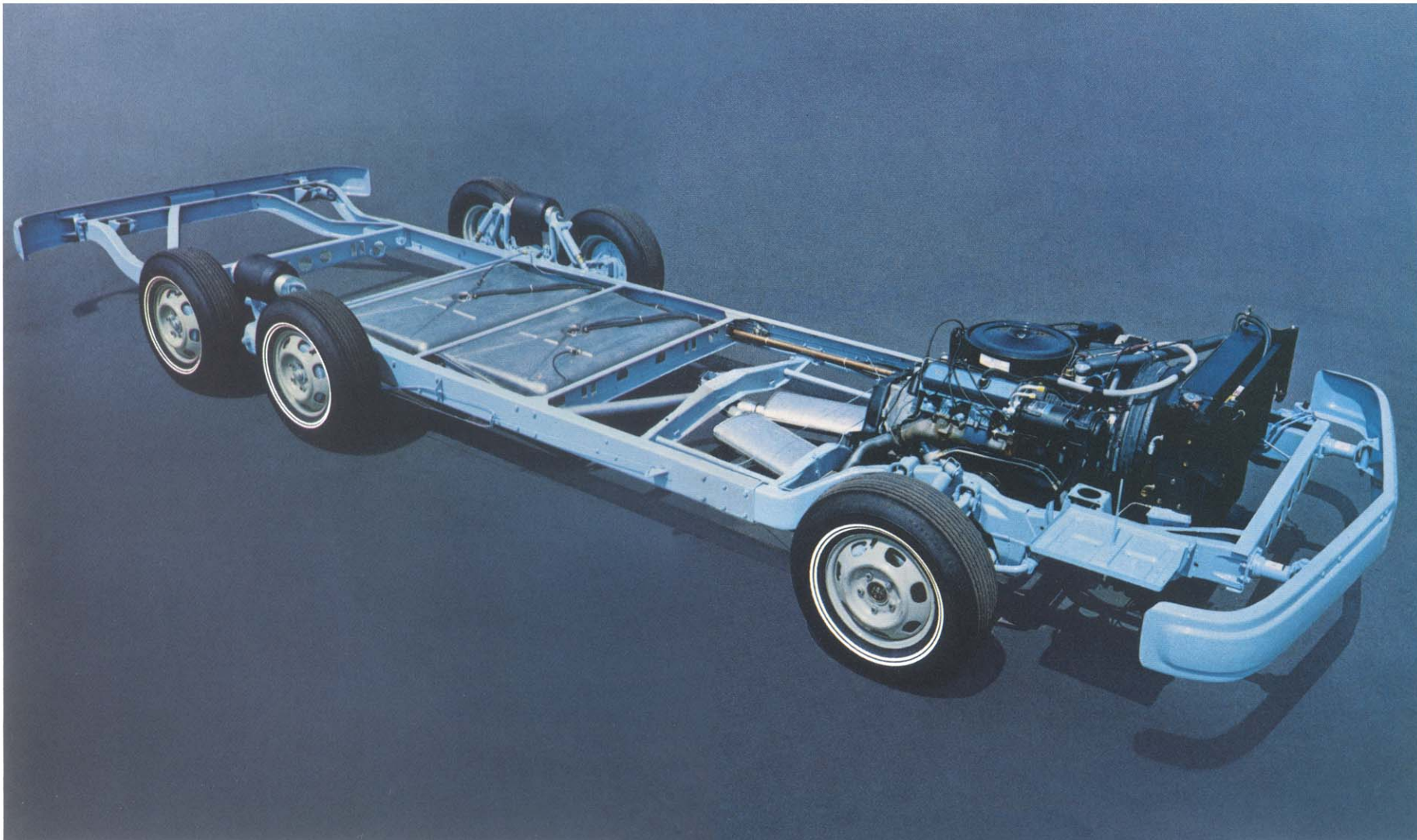

### **The MotorHome Suspension. Why it doesn't ride like a truck. Or handle like a barge.**

Since we weren't just putting a house on a truck chassis, we could design a rear suspension that would be well suited to motorhome use. In fact, we engineered a ride system that's nearly as much at home on a rutted country road as on an Interstate Highway. You won't find anything like it on any other motorhome.

There are four rear wheels. In tandem, not dual. Suspended on air, not steel springs. The combination produces more than just a smooth ride. It gives the

MotorHome a wide stance for increased stability. As well as keeping the rear wheels from protruding into the passenger space. Also, four wheels let us put in four large, finned drum brakes for added braking ability. And even the parking brake is applied to all four rear wheels.

The air springs are located between each pair of rear wheels so that road shock at one wheel is passed on to the other wheel.

The front suspension is torsion bar sprung, with stabilizer bars.

And there's an automatic leveling valve that keeps the rear suspension at the desired height.

**To make something  
very new,  
you have to start  
at the beginning.**

**We did.**

We wanted to build an ideal motorhome. So we went back to find out what would make it close to perfect. Not just features from other motorhomes, but basic design points that would give us the kind of motorhome that people wanted.

A low roofline was a must. And a low floor for easy entry and exit. Keeping everything low would also lower the center of gravity for easy handling. Yet, at the same time, we wanted plenty of headroom and the kind of ground clearance a real outdoor vehicle needs.

The biggest problem was the driveshaft and the rear axle. And that big bulge in the

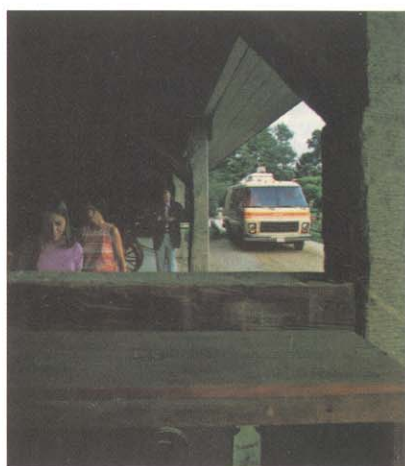

center of the axle.

So we got rid of them. We designed our MotorHome around a front-wheel drive unit. Thus, with all the machinery up front, a conventional rear axle and drive shaft is unnecessary. We designed simple support arms for the rear wheels and mounted them independently to the outside of an extra-wide chassis. That allowed plenty of interior width, a low floor, a 6-foot 4-inch ceiling, as well as the desired low roofline. Not to mention 8 inches of ground clearance.

And with that as a beginning, we knew our MotorHome was well on its way.





**GMC**

The MotorHome from General Motors.